

Installation for the DC1000U™ CSW200ULD™

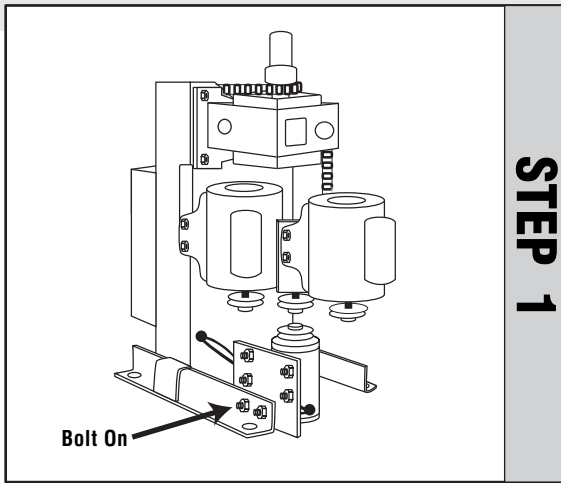

STEP 1

Remove existing belt and mount plate and new motor onto chassis, DO NOT fully tighten bolts.

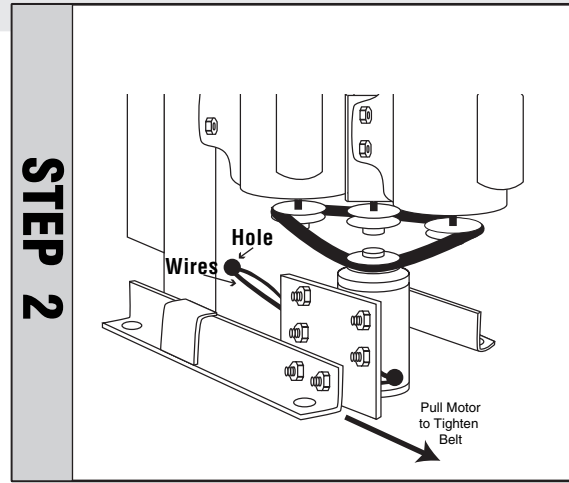

STEP 2

Put new belt in place around pulleys. **Make sure pulleys are in line.** Pull motor to tighten belt, then finish tightening bolts. Put 2 wires from new motor through appropriate hole in chassis as shown.

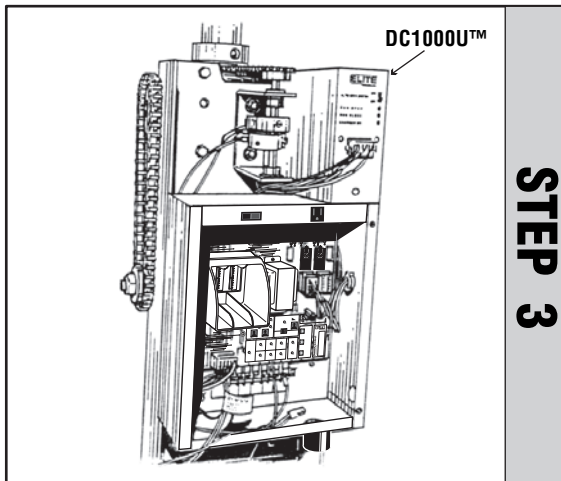

STEP 3

Place DC1000U™ unit on top of main control box and install 2 wires from in back of DC1000U™ to 2 wires from 12V motor, using wire nuts provided. **Crossing wires will change the direction the DC1000U™ will open.**

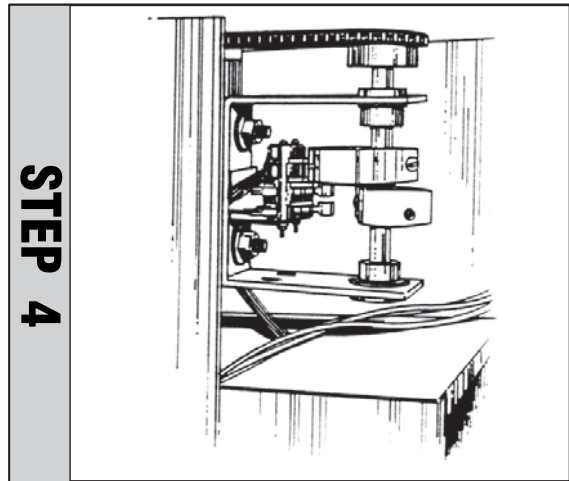

STEP 4

Mount new limit switches on top of existing limit switches. Wire new limit switches to DC1000U™ plug using wiring diagram on back of this sheet.

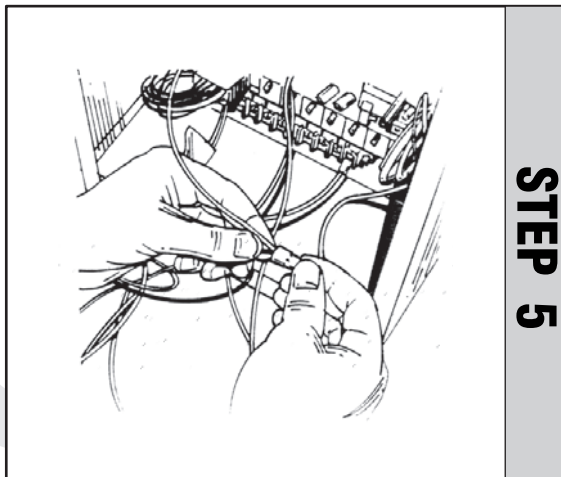

STEP 5

For Technical Support: 1-800-528-2806



CAUTION: DO NOT connect 120 Vac to DC1000U™. Connect the **HOT** wire from the power source to the **BLACK** wire from the DC1000U™ plug, Then the **BLUE** wire from the DC1000U™ plug to the **BLACK** wire on the operator. See diagram on back of this sheet.

CHAMBERLAIN®

ELITE™

© 2004 The Chamberlain Group, Inc.
All Rights Reserved

Installation for the DC1000U™ CSW200UL™

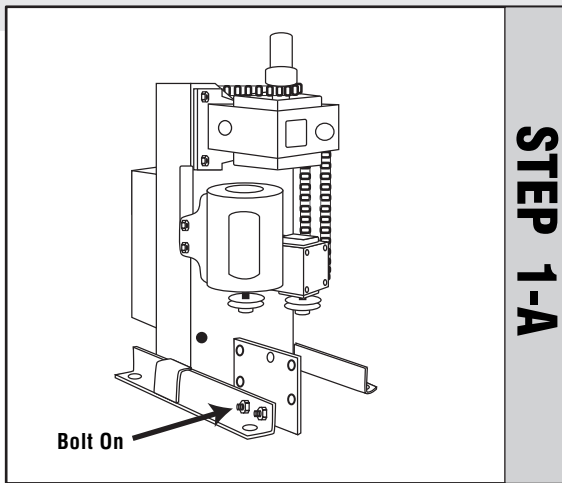

STEP 1-A

Remove existing belt. Mount new plate on chassis. Bolt in place (as shown) with bolts provided.

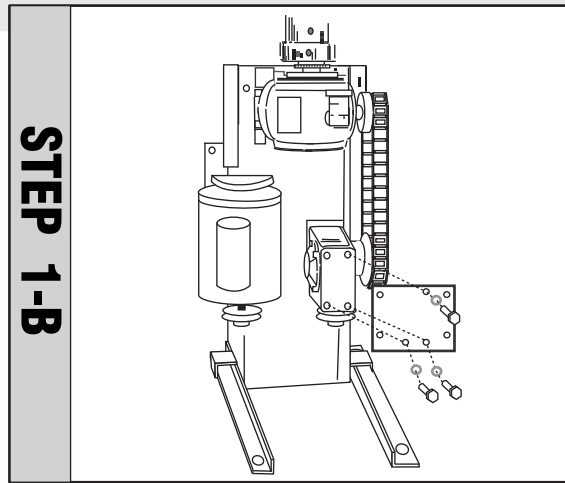

STEP 1-B

Remove existing belt. Mount new plate on lower gearbox. Bolt in place (as shown) with bolts provided.

OR

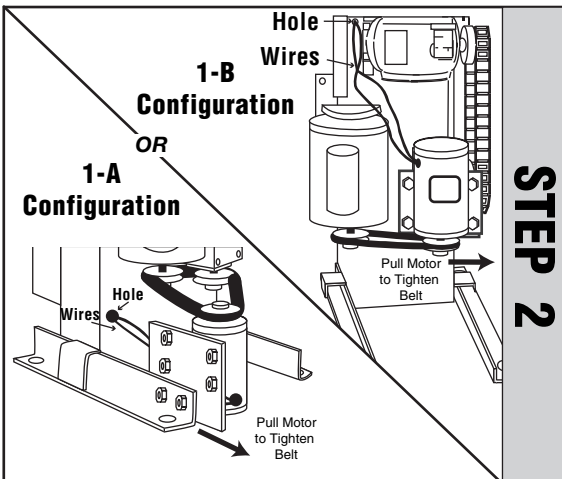

STEP 2

Bolt DC motor to plate of Step 1A OR 1B. Put new belt in place around pulleys. **Make sure pulleys are in line.** Pull motor to tighten belt, Then finish tightening bolts. Put 2 wires from new motor through appropriate hole in chassis as shown.

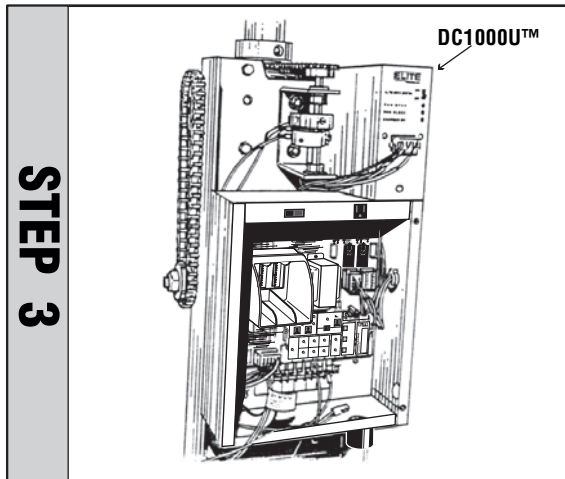

STEP 3

Place DC1000U™ unit on top of main control box and install 2 wires from in back of DC1000U™ to 2 wires from 12V motor, using wire nuts provided. **Crossing wires will change the direction the DC1000U™ will open.**

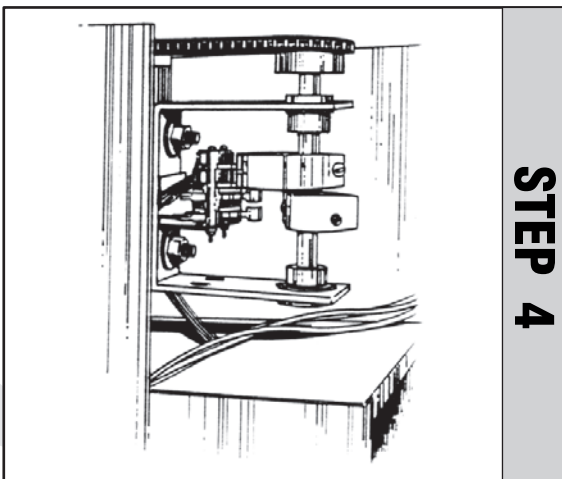

STEP 4

Mount new limit switches on top of existing limit switches. Wire new limit switches to DC1000U™ plug using wiring diagram on back of this sheet.

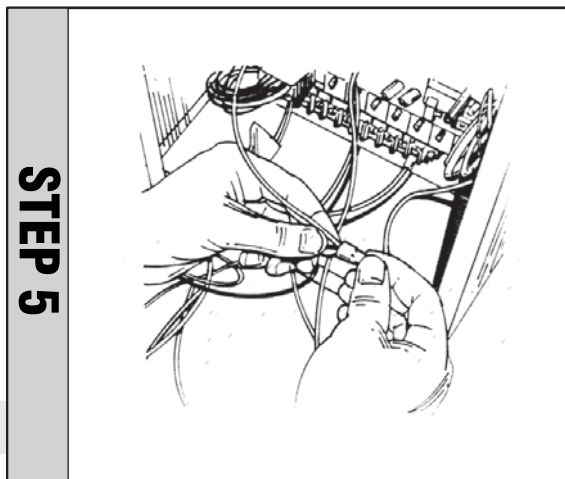

STEP 5



CAUTION: DO NOT connect 120 Vac to DC1000U™. Connect the HOT wire from the power source to the **BLACK** wire from the DC1000U™ plug, Then the **BLUE** wire from the DC1000U™ plug to the **BLACK** wire on the operator. See diagram on back of this sheet.

Wiring the DC1000U™ to a: Main Style Commercial Board

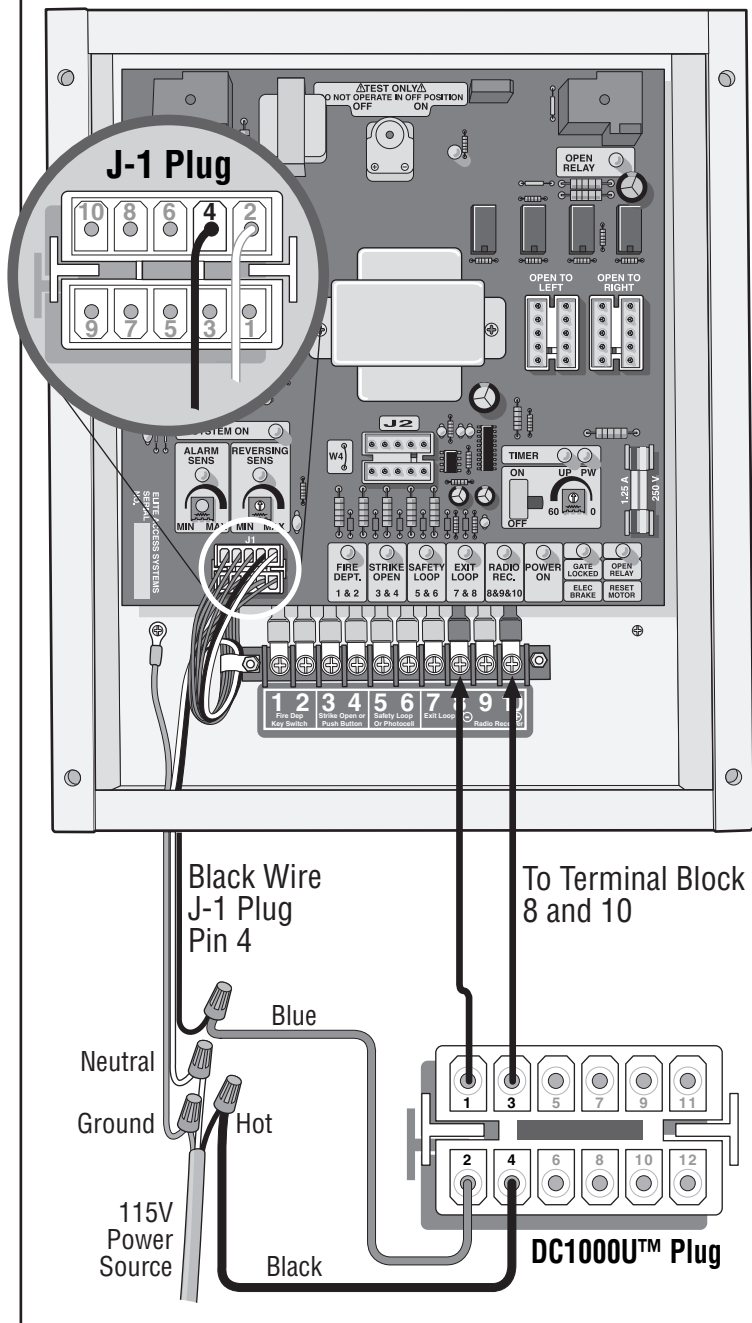

Wiring the DC1000U™ to a: OmniControl™ Board

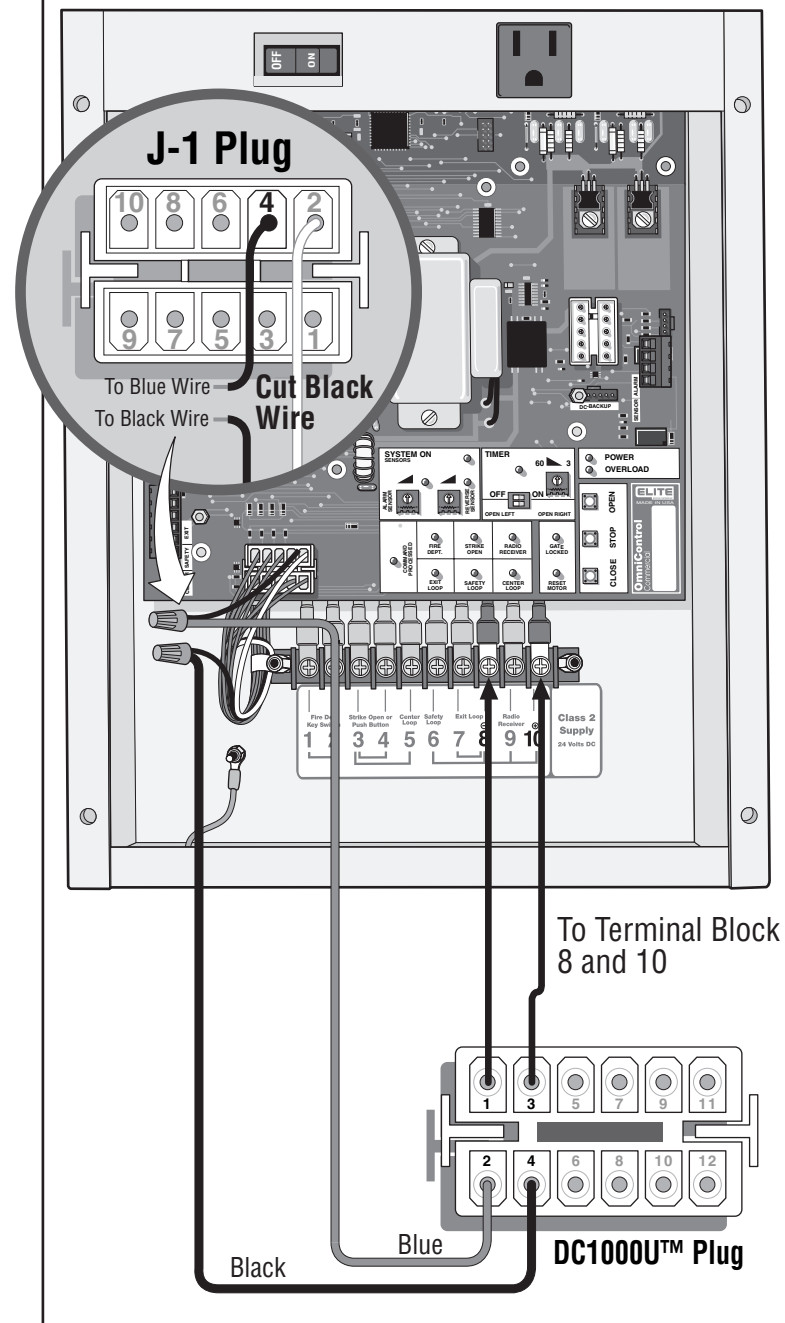

Wiring the DC1000U™ to a: OmniControl™ Board with Surge Suppressor

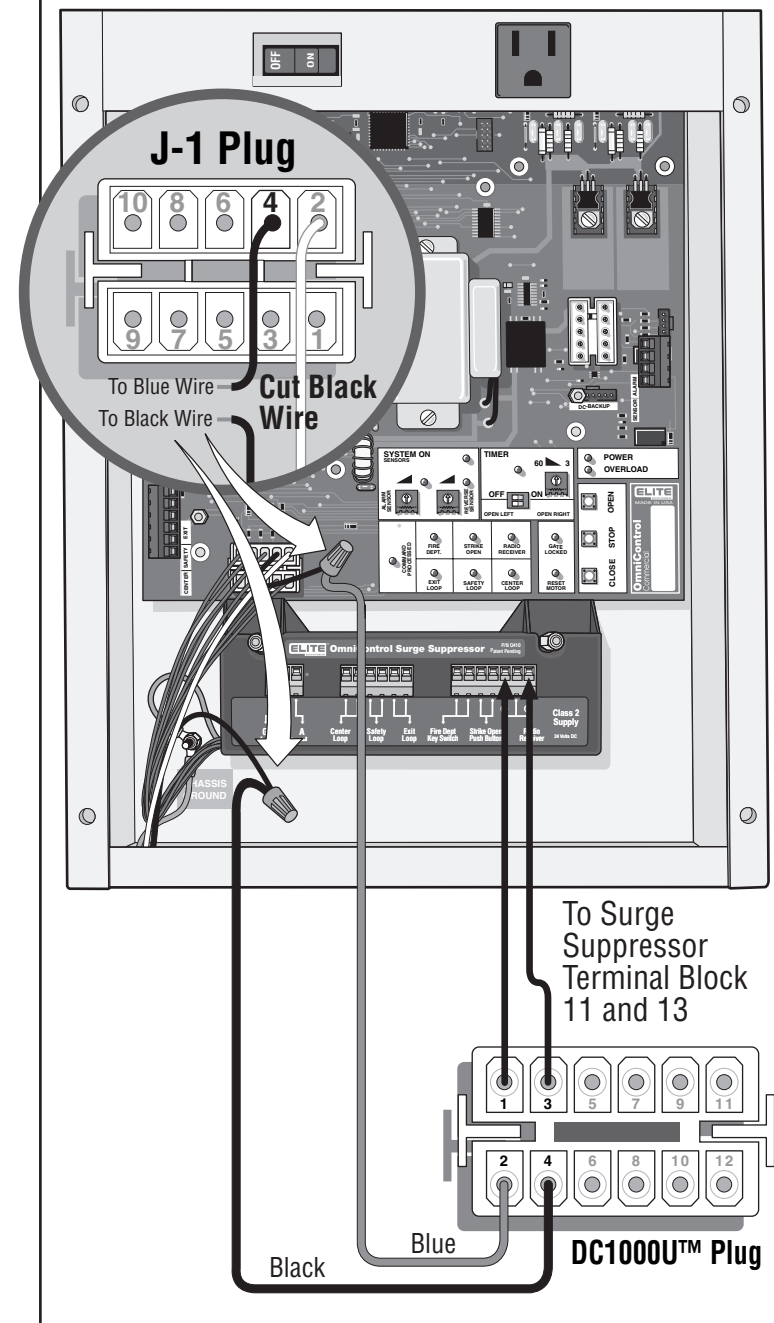

Wiring *Optional* Equipment to the DC1000U™

All devices wired to the DC1000U™ are dedicated to it alone. Normal operation will be controlled by separate devices wired to the operator control board.

Close Buttons, Key Switches, Etc.

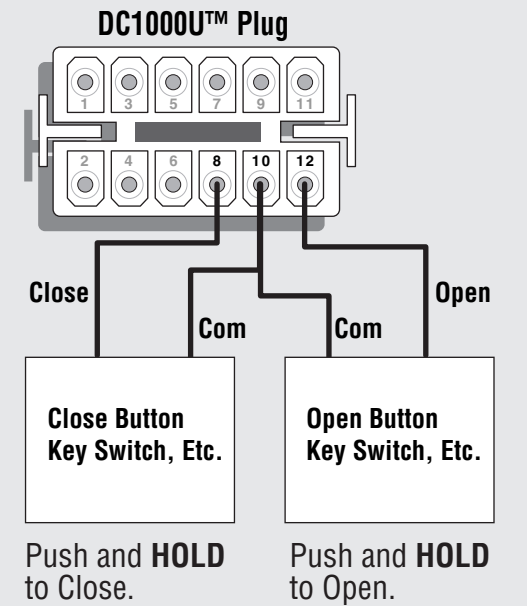

Radio Receivers 12V

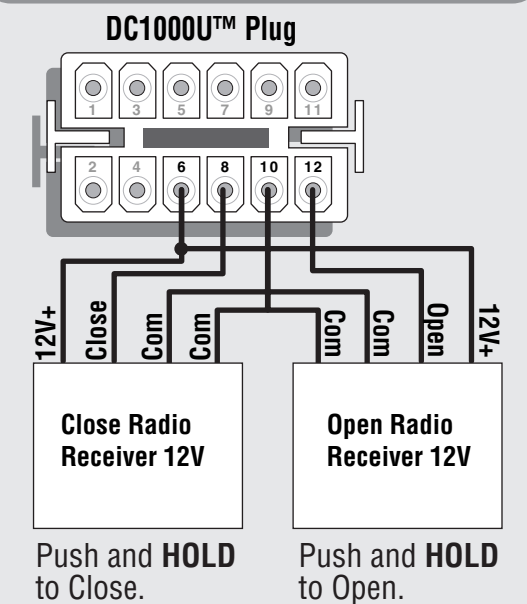

Wiring the DC1000U™ New Limit Switches

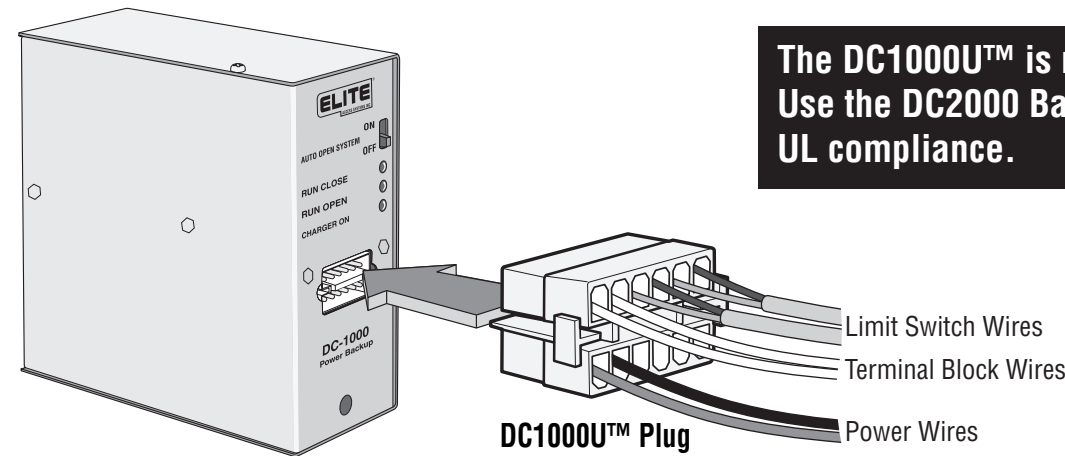
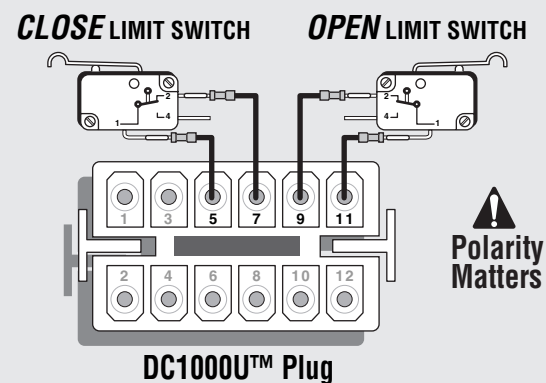

The DC1000U™ is not UL approved.
Use the DC2000 BackUp to Retain
UL compliance.

For Technical Support: 1-800-528-2806

© 2004 The Chamberlain Group, Inc.
All Rights Reserved

CHAMBERLAIN®
ELITE™

845 Larch Avenue Elmhurst, Illinois 60126
www.chamberlain.com